

OTIN

227-011285033290050

OTIN LENS M ROUND R RECESSED DOWNLIGHT made of aluminium, white, similar to RAL 9016, decor Faceted plastic reflector white matt, Microstructured lens optics beam 60°, light output direct, UGR <19, with converter, max. 500mA, dimmability: not dimmable, through wiring 2,5mm², IP54/IP20 with X-Change light source, replaceable without tools,

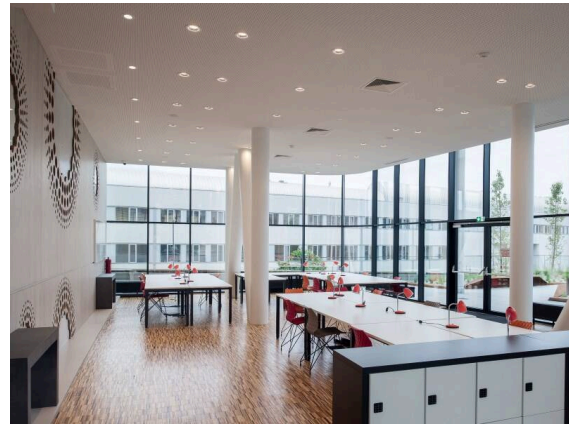

SKETCH

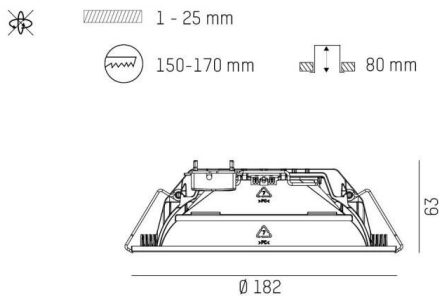

TECHNICAL DETAILS

Light source	LED
System performance [W]	18,5
Luminous flux [lm]	2520
Current sec. [mA]	500
Colour temperature	3000K
CRI	>90
UGR	<19
Optics	Microstructured lens optics
Converter	with converter
Dimmability	not dimmable
Light emission area	direct
Beam angle	60°
Voltage	220-240V AC/DC
Through wiring	2,5mm²

Height [mm]	63
Diameter [mm]	182
Ceiling cutout [mm]	150-170
Ceiling thickness [mm]	1-25
Mounting depth [mm]	80
IP protection class	IP54/IP20
IP protection class	protection cl. II
IK value	IK02

Material	aluminium
Colour of body	white
RAL	9016
Colour of decor	Faceted plastic reflector white matt
Lifetime [h]	L90 B10 50 000
Energy efficiency class	D
Number of luminaires B16A	45

Net weight [kg]	0.53
EAN number	9010979235038

LIGHT DISTRIBUTION CURVE

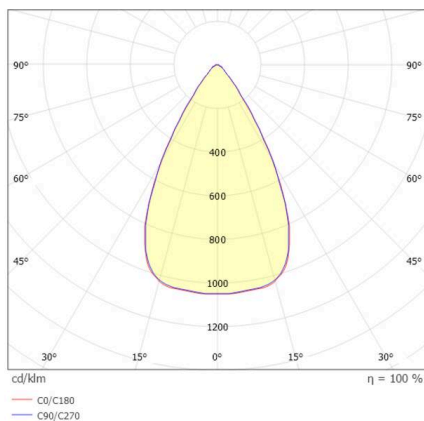

Energy label



The values are rated values. Power and luminous flux are initially subject to a tolerance of +/- 10%. Colour temperature tolerance: +/- 150 K. The values apply to an ambient temperature of 25°C unless otherwise specified.